

Masic Yard

5650 West 2300 South
West Valley City, UT 84120



LAND / INDUSTRIAL | FOR SALE / LEASE

Land with industrial buildings available. The main building consists of an office front reception counter and warehouse. The second building can be used as an additional office space or storage. The third building is an observation tower.

PROPERTY INFORMATION

- > Sales Price: \$3,500,000
- > Lease Rate: \$10,000/mo NNN
- > 2.62 acres
- > Main building is 2,400 SF and has 3 ground level doors
- > Second building (dry storage) is 738 SF
- > Third building is a 2-story guard tower 10' x 14'
- > Paved and gravel fenced yard
- > Located close to Mountain View Corridor and Hwy 201
- > Easy access to SLC Intl. Airport and downtown SLC
- > Abutting 0.91 acres also for sale for a total of 3.53 acres when purchased together.



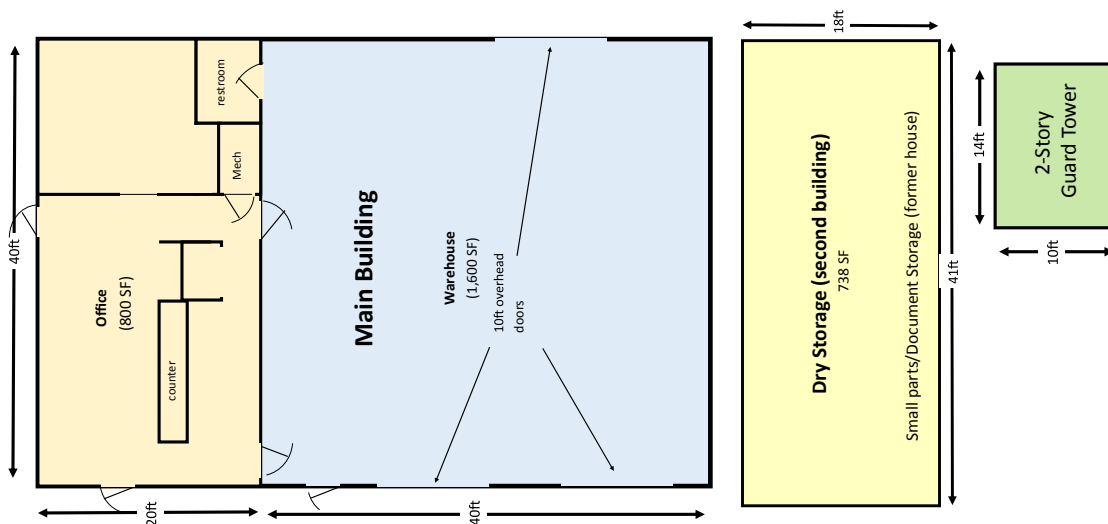
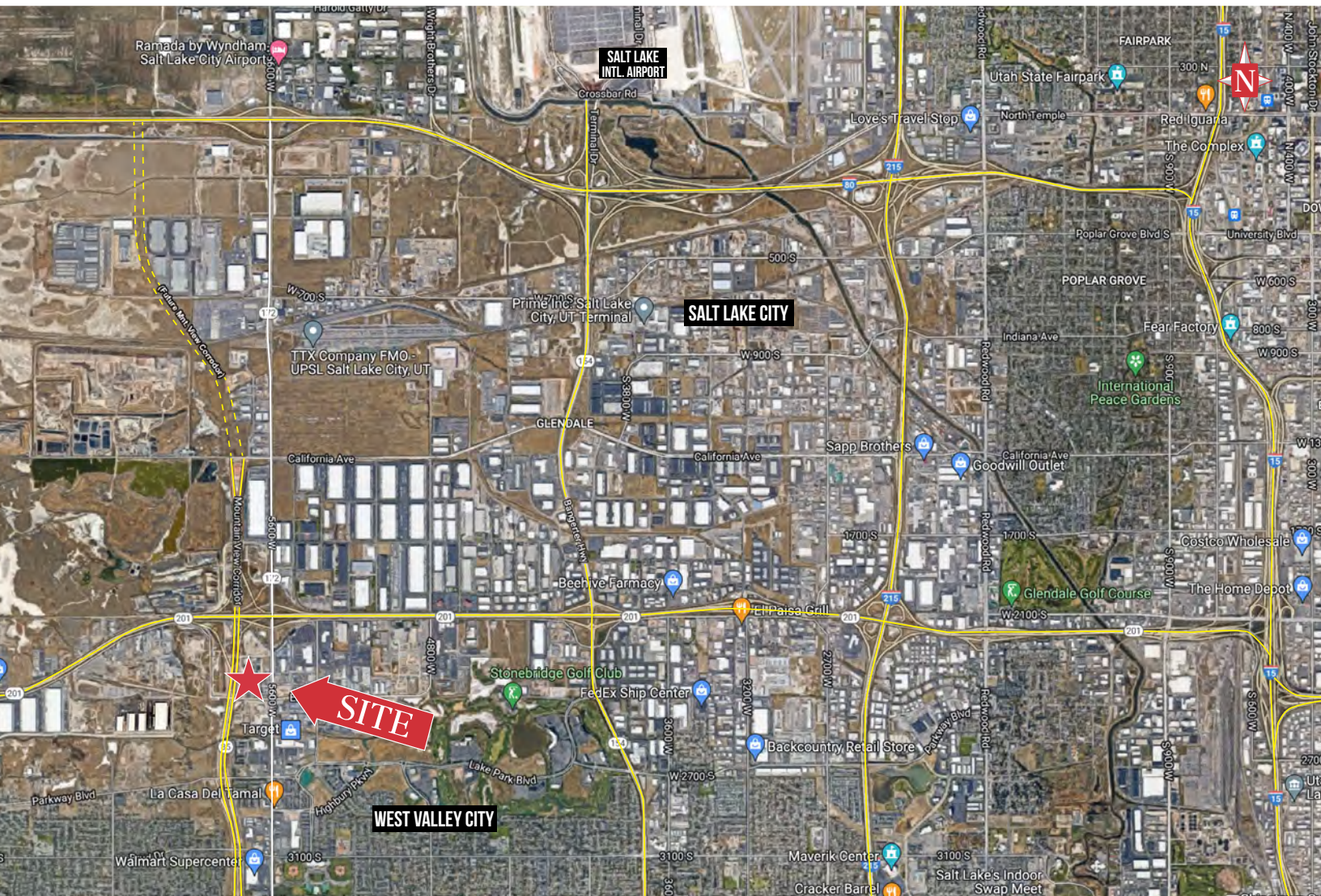

NAIPremier

7455 Union Park Avenue Ste. A, Midvale, Utah 84047

801 255 3333 | naipremier.com

NO WARRANTY OR REPRESENTATION, EXPRESS OR IMPLIED, IS MADE AS TO THE ACCURACY OF THE INFORMATION CONTAINED HEREIN, AND THE SAME IS SUBMITTED SUBJECT TO ERRORS, OMISSIONS, CHANGE OF PRICE, RENTAL OR OTHER CONDITIONS, PRIOR SALE, LEASE OR FINANCING, OR WITHDRAWAL WITHOUT NOTICE, AND OF ANY SPECIAL LISTING CONDITIONS IMPOSED BY OUR PRINCIPALS. NO WARRANTIES OR REPRESENTATIONS ARE MADE AS TO THE CONDITION OF THE PROPERTY OR ANY HAZARDS CONTAINED THEREIN ARE ANY TO BE IMPLIED.